

Détail A / Detail A
BORNES HT / HV TERMINALS

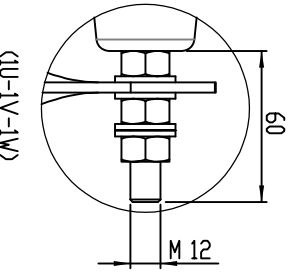

Détail B / Detail B
BORNES BT / LV TERMINALS

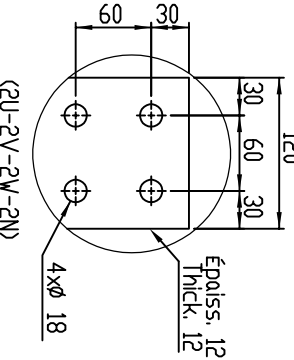

ITEM	DESCRIPTION
01	BORNES HT LATION / HV TERMINALS BRASS (1U-1V-1W)
02	BORNES BT ALUMINIUM / LV TERMINALS ALUMINIUM (2U-2V-2W)
03	BORNE DE NEUTRE / NEUTRAL TERMINAL POINT (2N)
04	PLAQUE CARACTERISTIQUE / RATING PLATE
05	BOTE AUXILIAIRES/ AUXILIARY CIRCUIT BOX
06	ANNEAUX DE LEVAGE / LIFTING EYES
07	BORNIER DE COMMUTATION / DFT-CIRCUIT VOLTAGE REGULATION
08	ROUES ORIENTABLES / BI-DIRECTIONAL WHEELS
09	BORNE DE TERRE / EARTHING TERMINALS
10	TROUS POUR TRACTION / PULLING HOLES
11	VENTILATEURS / COOLING FANS
12	BOTE AUXILIAIRES POUR VENTILATEURS / AUXILIARY CIRCUIT BOX FANS

MASSE / MASS IP00 : 4400 kg

	Scale	1:8			
	Orientation				
	Rev	03	02	01	00
	Modification				
	Issue				
	Date				
	Des. / Drawn/Contr.				
	Checked				
	Fantozzi				
	05/09/2019				
	Reproduction interdite. Tutti i diritti sono riservati. / All rights reserved.				

© Bkano SpA
Via Luigi Barbi, 231
2100 Verese (VA) - Italy
Tel. +39 0332 279111
Fax +39 0332 279266

Type de Dessin / Drawing Type	ENCADREMENT OUTLINE DIMENSIONS
Client / Customer	ZMGN03100102311
Puissance Rating	1600
Tension Voltages	33000 ± 2 x 1500V / 400
Code	ZMGN03100102311
QVA/Free	50
Groupage	Dyn11
Nome Dessin / Drawing feuille/Sheet	IN1108700
per/of	1/1
GENERAL TOLERANCES + / -	20mm